

QL-15F load cells are available in the capacities from 50kg to 300kg.

Alloy aluminum construction with parallel beam type.

Silicon adhesive sealed, surface anodized and anti-corrosion.

Integral structure and easy installation.

Suitable for electronic counting scales, platform scales, electronic balance and other electronic weighing devices.



Features:

Capacity : 50kg to 300kg

Defend grade:IP65

High accuracy.

Alloy aluminum parallel beam

Max. platform size:250x350mm

Integral structure, reliable performance, and easy installation

Electrical connection and Dimensions:

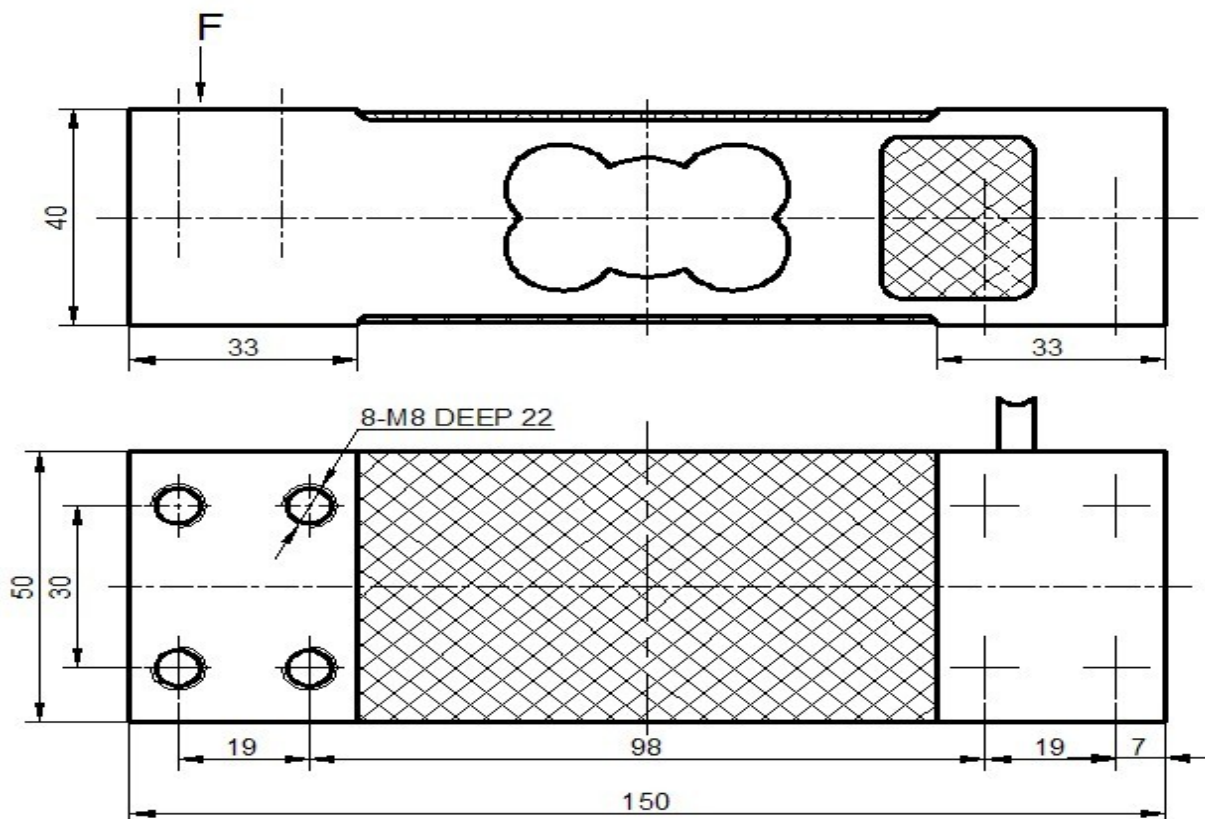

QY Electronic Co Ltd

Address: No. 1032, Xinghan Road, Hantai District, Hanzhong, Shaanxi, China (Mainland)

Website: www.qysensor.com

TEL: +86-(0)916-2257989

E-mail: info@qysensor.com

Zip: 723000

Technical Specifications

| Specifications: | | |
|---------------------------------|-----------|------------------------|
| capacity | kg | 50, 80,100,150,200,300 |
| safe overload | %FS | 120 |
| ultimate overload | %FS | 150 |
| rated output | mV/V | 2.0 ± 0.2 |
| excitation voltage | Vdc | 5 ~ 15 |
| combined error | %FS | ± 0.02 |
| zero unbalance | %FS | ± 2 |
| non-linearity | %FS | ± 0.02 |
| hysteresis | %FS | ± 0.02 |
| repeatability | %FS | ± 0.01 |
| creep | %FS/30min | ± 0.02 |
| input resistance | Ω | 406 ± 10 |
| output resistance | Ω | 350 ± 3 |
| insulation resistance | M Ω | ≥ 5000 @ 50 Vdc |
| operating temperature range | °C | -20 ~ +60 |
| compensated temperature range | °C | -10 ~ +40 |
| temperature coefficient of SPAN | %FS/10°C | ± 0.02 |
| temperature coefficient of ZERO | %FS/10°C | ± 0.03 |

Electrical connection:

Excitation+ red Excitation- black Signal+ green Signal- white

Four-core shielded cable with polyethylene. Cable is not connected with elastomer.

Cable length: 0.45 m

Cable diameter : 4 ±0.2 mm

The cable length could be chose by customer's application.