

QH-21D load cells are available in the capacities from 0.5t to 2t.
Alloy steel & stainless steel construction with single shear beam type.
Silicon adhesive sealed inside, waterproof, anti-corrosion and suitable for all kinds of environment.
Integral structure and easy installation.
Suitable for electronic platform scales, truck scale, floor scale, hopper scale and other electronic weighing devices.



Features:

Capacity : 0.5t to 2t
Defend grade: IP66
High accuracy.
Alloy steel & stainless steel single shear beam
Low profile and nice exterior.

Electrical connection and Dimensions:

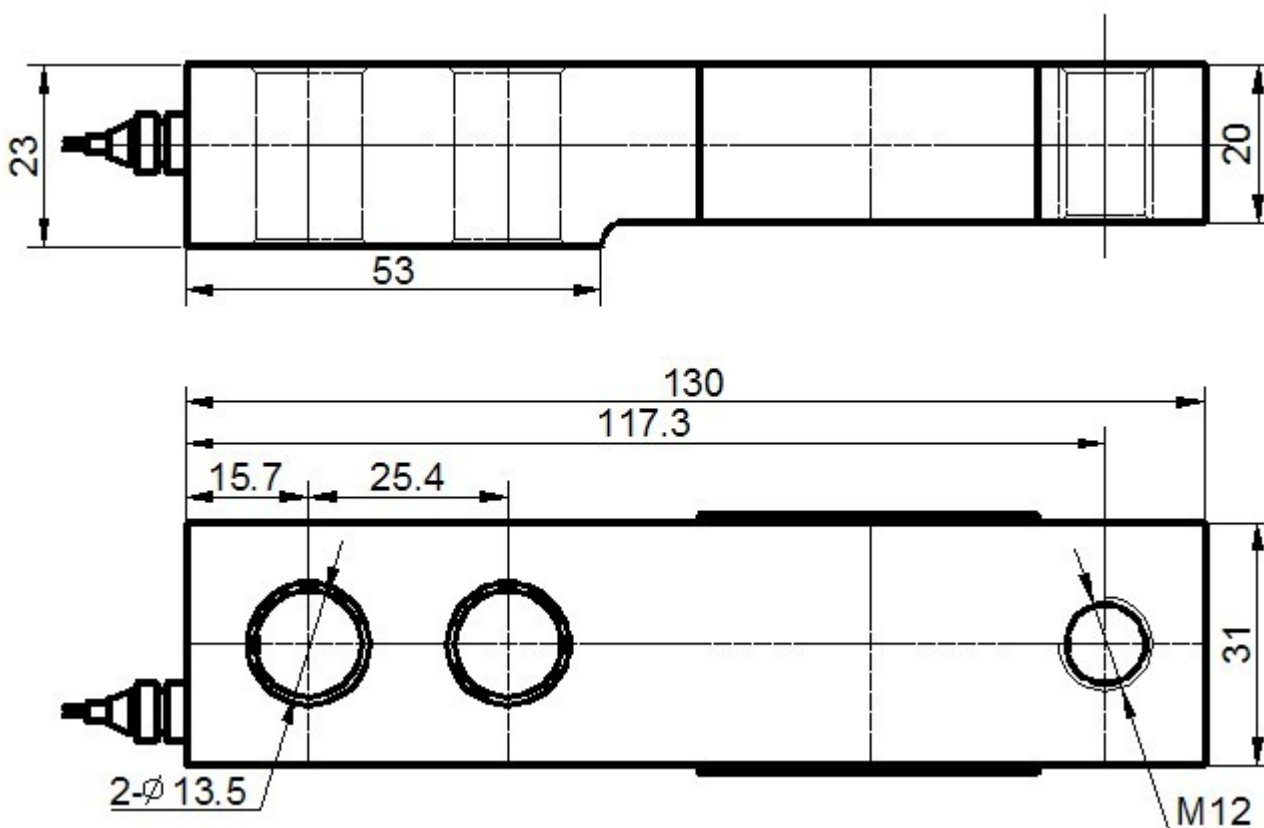

QY Electronic Co Ltd

Address: No. 1032, Xinghan Road, Hantai District, Hanzhong, Shaanxi, China (Mainland)

Website: www.qysensor.com

TEL: +86-(0)916-2257989

E-mail: info@qysensor.com

Zip: 723000

Technical Specifications

Specifications:		
capacity	t	0.5, 1, 1.5, 2,
safe overload	%FS	150
ultimate overload	%FS	200
rated output	mV/V	2.0 ± 0.003
excitation voltage	Vdc	9 ~ 12
combined error	%FS	± 0.03
zero unbalance	%FS	± 1
non-linearity	%FS	± 0.03
hysteresis	%FS	± 0.03
repeatability	%FS	± 0.02
creep	%FS/30min	± 0.03
input resistance	Ω	350 ± 5
output resistance	Ω	350 ± 3
insulation resistance	M Ω	≥ 5000 @ 50 Vdc
operating temperature range	°C	-20 ~ +55
compensated temperature range	°C	-10 ~ +40
temperature coefficient of SPAN	%FS/10°C	± 0.02
temperature coefficient of ZERO	%FS/10°C	± 0.03

Electrical connection:

Excitation+ red Excitation- black Signal+ green Signal- white

Four-core shielded cable with polyethylene.

Cable diameter : \varnothing 5mm

Cable length: 3 m

The cable length could be chose by customer's application.