

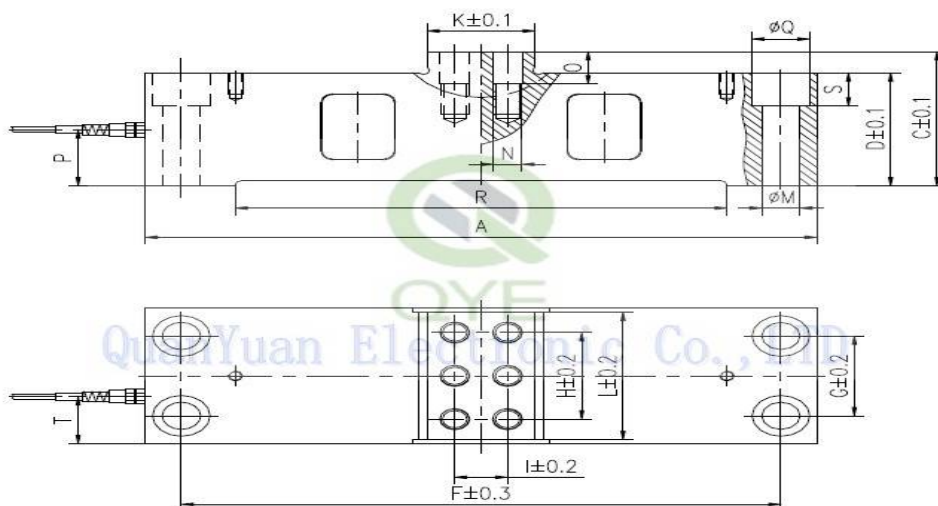

Feature:

1. Alloy steel material, and reliable performance
2. Reasonable structure, installation components is simple and reliable.
3. Measuring range is from 25t to 200t.
4. The type of outlet is 6-wires.
5. The range of operating temperature is from 0°C to 200°C
6. Suitable for the ladle weighting system of metallurgical industry, and other high temperature weighting system.

Dimensions: (unit: mm)



Capa (t)	Size(mm)																	
	A	B	C	D	F	G	H	I	K	L	M	N	O	P	R	S	T	Q
25	385	100	120	95	312	48	64	38	76	90	18	M16×25	20	40	260	24	42	26
50	450	120	130	105	398	68	75	40	80	110	26	M20×30	32	45	340	31	48	40
100	500	140	143	118	444	80	90	44	90	130	32	M24×36	38	54	370	39	54	48
150	560	160	158	133	500	94	102	44	90	150	32	M24×36	38	66	410	39	56	48
200	620	180	175	150	560	114	110	44	90	160	32	M24×36	40	75	450	39	60	48

Technical Specification:

Capacity	t	25.50.100.150.200	
Rated output	mv/v	1.5±0.003	
Accuracy	%FS	±0.05	±0.1
Linearity	%FS	±0.05	±0.1
Hysteresis	%FS	±0.05	±0.1
Repeatability	%FS	±0.03	±0.05
Creep	%FS/30min	±0.05	±0.05
Temperature coefficient of SPAN	%FS/10℃	±0.03	±0.05
Temperature coefficient of ZERO	%FS/10℃	±0.03	±0.05
Zero unbalance	%FS	±1	
Safe overload	%FS	150	
Input resistance	Ω	800±50	
Output resistance	Ω	702±3	
Insulation resistance	M Ω	> 3000 (50 Vdc)	
Excitation voltage	V	10(DC)	
Max.excitation voltage	V	15(DC)	
Operating temperature range	℃	0 ~ +200	
Compensated temperature range	℃	0 ~ +200	
Environment protection	IP67		
Electrical connection	Six-core - ∅ mm,Shielded cable:18m Excitation+ green Signal+white Feedback+yellow Excitation-brown Signal-red Feedback-bule Shield(longer):yellow		