

QL-51 miniature sensor are available in the capacities from 20g to 100g.

Aluminum-alloy construction with parallel beam type, silicon adhesive sealed, surface anodized and anti-corrosion.

Integral structure and easy installation.

Suitable for electronic balance and other high accuracy electronic weighing devices.



Features:

Capacity : 20g to 100g

Defend grade: IP65

High accuracy,parallel beam type, reliable performance.

Integral structure and easy installation.

Recommended platform size: 50x50mm

Electrical connection and Dimensions:

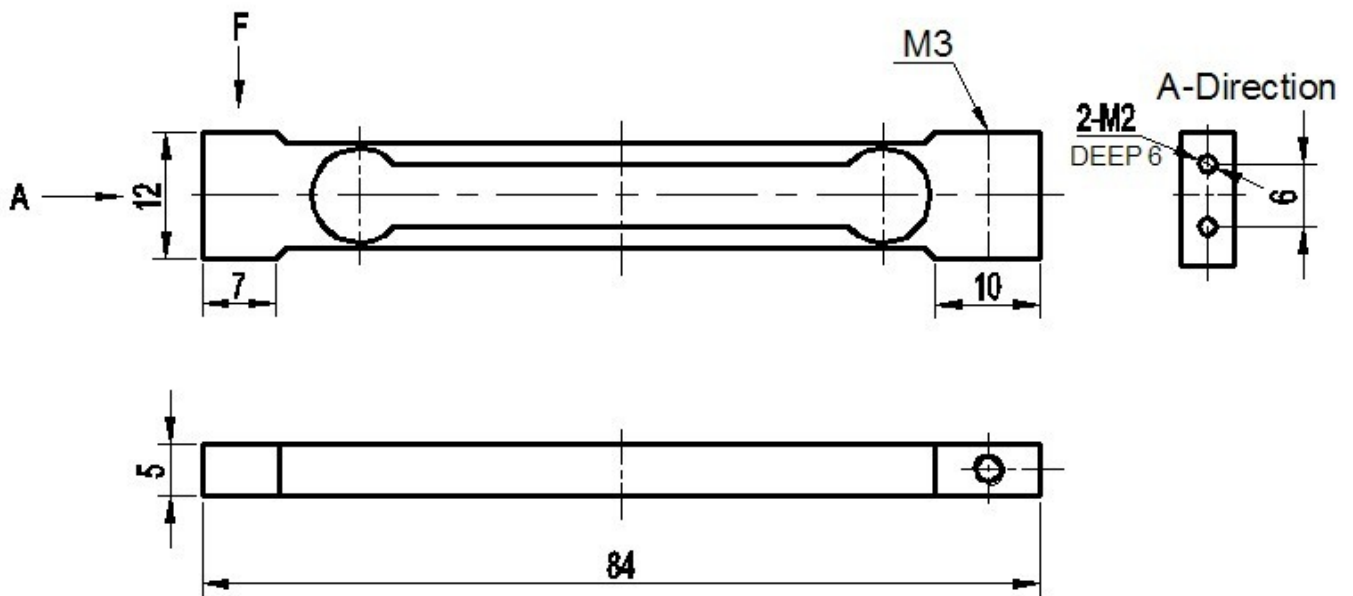

QY Electronic Co Ltd

QL-51

Technical Specifications

Specifications:		
Capacity	g	20, 30, 50, 100
Safe overload	%FS	120
Ultimate overload	%FS	150
Rated output	mV/V	0.5±0.15
Excitation voltage	Vdc	≤6
Combined error	%FS	± 0.05
Zero unbalance	mV/V	± 0.5
Non-linearity	%FS	± 0.05
Hysteresis	%FS	± 0.05
Repeatability	%FS	± 0.05
Creep	%FS/3min	± 0.05
Input resistance	Ω	1055 ± 40
Output resistance	Ω	1000 ± 10
Insulation resistance	M Ω	≥ 2000 @ 50 Vdc
Compensated temperature range	°C	-10 ~ +40
Temperature coefficient of SPAN	%FS/10°C	± 2.0
Temperature coefficient of ZERO	%FS/10°C	± 0.05

Electrical connection:

Excitation+ red Excitation- black Signal+ green Signal- white

Four -color one line

Cable length: 120mm.

QY Electronic Co Ltd

Address: No. 1032, Xinghan Road, Hantai District, Hanzhong, Shaanxi, China (Mainland)

Website: www.qysensor.com

TEL: +86-(0)916-2257989

E-mail: info@qysensor.com

Zip: 723000