

QH-64 load cells are available in the capacities from 0.5kg to 200kg
 Alloy steel or aluminum alloy construction with spoke type.
 Silicon adhesive sealed inside, waterproof, anti-corrosion and suitable for all kinds of environment.
 Suitable for industrial control, dosing systems and other electronic weighing systems.



Features:

- Capacity: 0.5kg to 200kg.
- IP rating: IP66
- Tension and/or compression loading.
- Reliable performance, integral installation and easy installation.

Electrical connection and Dimensions:

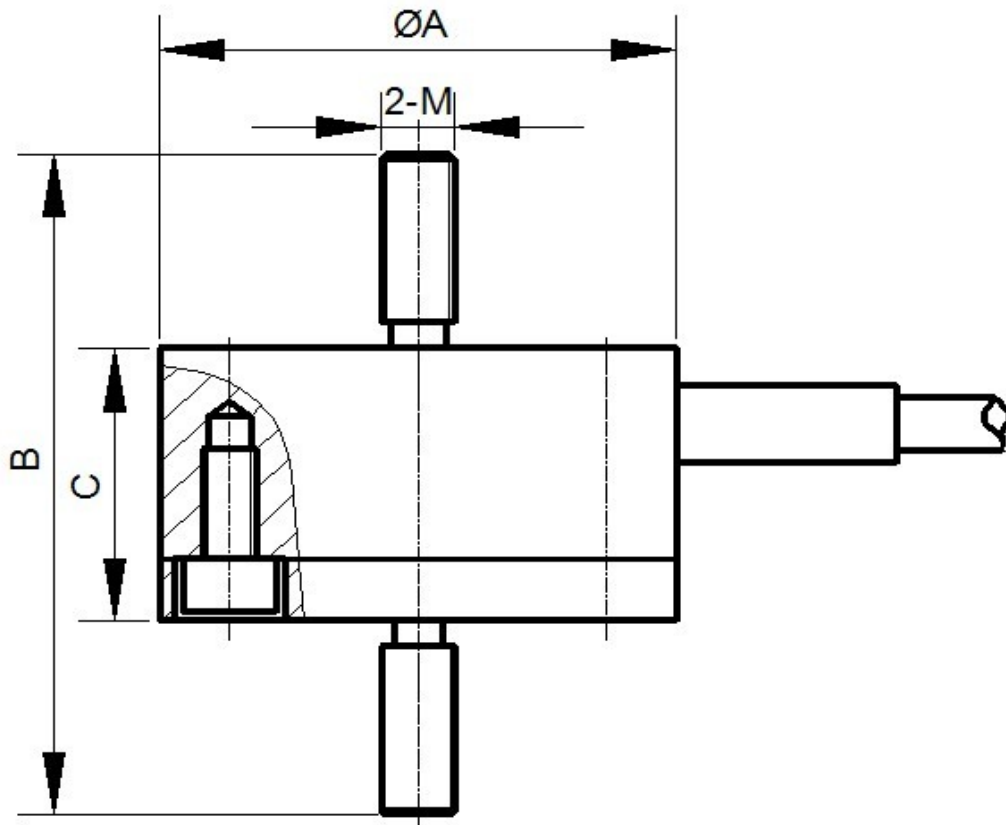

Cap(kg)	A	B	C	M
0.5~5	28.2	38.2	16.2	M4x0.7
10~200	33.1	46.2	22.1	M6x1

Technical Specifications

QY Electronic Co Ltd

Address: No. 1032, Xinghan Road, Hantai District, Hanzhong, Shaanxi, China (Mainland)

Website: www.qysensor.com

E-mail: info@qysensor.com

TEL: +86-(0)916-2257989

Zip: 723000

Specifications:		
Capacity	kg	0.5,1,2,5,10,20,50,100,200
Safe overload	%FS	150
Ultimate overload	%FS	200
Rated output	mV/V	1.0 ± 0.1
Excitation voltage	Vdc	9 ~ 12
Combined error	%FS	± 0.2
Zero unbalance	%FS	± 10
Non-linearity	%FS	± 0.2
Hysteresis	%FS	± 0.2
Repeatability	%FS	± 0.1
Creep	%FS/30min	± 0.1
Input resistance	Ω	350 ± 10 & 700±10
Output resistance	Ω	350 ± 10 & 700±10
Insulation resistance	M Ω	≥ 2000 @ 50 Vdc
Operating temperature range	°C	-20 ~ +55
Compensated temperature range	°C	-10 ~ +40
Temperature coefficient of SPAN	%FS/10°C	± 0.5
Temperature coefficient of ZERO	%FS/10°C	± 0.5

Electrical connection:

Excitation+ red Excitation- black Signal+ green Signal- white

Four-core shielded cable with polyethylene.

Cable diameter : \varnothing 3mm

Cable length: 2m

The cable length could be chose by customer's application.