

QL-56C mini load cells are available in the capacities from 300 g to 1500 g.
Aluminum alloy construction with parallel beam type.
Silicon adhesive sealed, surface anodized and anti-corrosion.
Integral structure and easy installation.



Features:

1. Capacity : 300g-1.5Kg
2. High accuracy 0.02%FS
3. Aluminum alloy parallel beam load cell
4. Integral installation

Electrical connection and Dimensions:

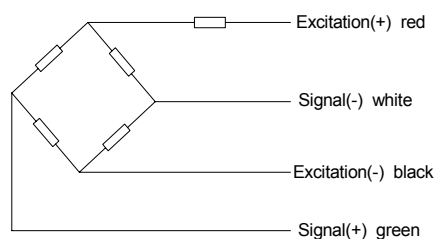
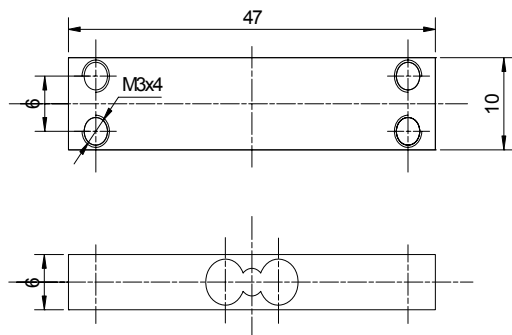

Technical Specifications

Specifications:		
capacity	Kg	0.3……1.5
safe overload	%FS	150
rated output	mV/V	0.9 ± 0.2
excitation voltage	Vdc	≤ 10
combined error	%FS	0.02
zero unbalance	mV/V	± 0.1
non-linearity	%FS	± 0.1
hysteresis	%FS	± 0.1
repeatability	%FS	± 0.1
creep	(5min) %FS	± 0.05
input resistance	Ω	1000 ± 10
output resistance	Ω	1000 ± 10
insulation resistance	M Ω	$\geq 2000 @ 50 \text{ Vdc}$
operating temperature range	$^{\circ}\text{C}$	0 ~ +50
temperature coefficient of SPAN	%FS/ 10°C	± 0.1
temperature coefficient of ZERO	%FS/ 10°C	± 0.1

Electrical connection:

- Excitation+ red Excitation- black Signal+ green Signal- white
- Four -color single line
- Cable length: 120mm
- Cable diameter: 0.6 ± 0.1 mm